

HAL-TEX 20 MINUTE

Breather Type Building Paper

Description

A kraft paper which has been saturated with asphalt. This grade D building paper sheds water and restricts moisture from penetrating. However, it will allow the passage of water vapour, thus permitting wood to "breathe".

Uses

Used on outside walls of wood frame buildings, under the external finish, as a secondary protective barrier against entry of wind and moisture. This product is designed for applications in which minimum water resistance is required. For applications requiring greater water resistance we recommend HAL-TEX "30" or HAL-TEX "60". Also can be applied under roofing shingles to prevent wind-blown moisture from reaching wood roof decking.

Specifications

Conforms to:	CAN 2-51.32M77 and U.S. Federal Specification UU-B-790a, Type I, Grade "D" Style 2
Weight per roll:	15 lbs. Approx. (6.8 Kg)
Rolls width:	1016 mm (40")
Contents:	37.2 m ² (400 ft ²)
Reference:	CCMC Listing No. 11479-L

Packaging

Rolls per pallet:	100
Pallet size:	48" x 40"

Method of Application

- Follow all requirements of the governing building code for the jurisdiction of use.

Figure 1: HAL-TEX 2-Ply Installation Guide

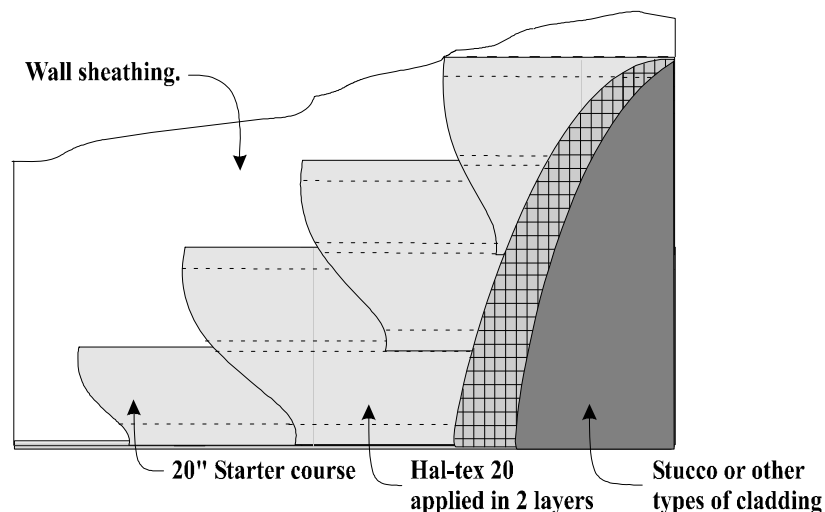

Continued on next page

HAL-TEX 20 MINUTE Cont'd

- **Exterior Wood Frame Walls:** (*NOTICE: REVISED APPLICATION METHOD*)

As per above Figure 1. Two layers are recommended to be installed under all types of cladding.

Step 1. Begin by installing a 508 mm (20") half roll as a starter course horizontally 50 mm (2") below the lowest point of the wood framing.

Step 2. Install a full width 1016 mm (40") sheet completely over the starter course.

Step 3. Continue half-lapping up the wall in shingle fashion overlapping the top sheet down to the lower of the 2 lines in the center of the previously installed course. This line is 534 mm (21") down from the top of the sheet and allows a safety margin that ensures a 2-ply application. All tie-ins to window frames or other wall openings shall be sealed using a waterproof construction tape. Vertical laps shall be made where required and have a minimum 300 mm (12") overlap.

- **Lap Sealing and Damage control:**

For optimum protection against moisture entry product should be covered as soon as possible. All vertical laps shall be sealed with a waterproof construction tape. All fasteners shall penetrate the sheet in a neat fashion so as to minimize entry points for moisture. Wherever the sheathing is torn or damaged either by fasteners or in other ways, the holes or tears shall be sealed with a waterproof construction tape.

- **Drainage Cavity:**

For certain conditions a 10 mm drainage cavity is recommended behind cladding to prevent moisture entrapment which can lead to wood rot and mould growth. Such conditions occur where the wall has a high moisture loading potential in regions where there has been a history of moisture related wall failures such as coastal regions. Insufficient roof overhang and wind action can also contribute to this condition. Check with local professionals who are experts in building envelope design. As a drainage cavity is required for brick, we recommend that stone-facing should have a minimum 10 mm drainage cavity behind it.

The information presented herein, while not guaranteed, is to the best of our knowledge true and accurate. Except when agreed to in writing for specific conditions of use, no warranty or guarantee expressed or implied is made regarding the performance of any product, since the manner of use and handling are beyond our control. The user of such information assumes all risk connected with the use thereof. Nothing contained herein is to be construed as permission or as a recommendation to infringe any patent.